

## Sample Collection

- 1** • Instruct the donor not to place anything in the mouth including food, drink, gum or tobacco products for at least 10 minutes prior to collection.

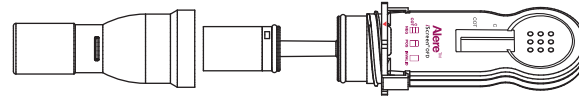

- 2** • Remove Sample Collector Protector.



- 3** • Insert Sponge end of collector into mouth.  
 • Actively swab the inside of the mouth and tongue with Sponge. As soon as the Sponge softens slightly, gently press the Sponge between the tongue and teeth to ensure **complete saturation**. The Sponge is saturated when no hard spots can be felt. Collect for at least three (3) minutes before removing Sponge.  
 • Hand the saturated collector over to the tester.



## Testing

- 1** A. Insert the collector **vertically** into the Cap and **press down firmly** until the Cap reaches the thread.  
 B. Twist the Handle clockwise 180° to tighten the Cap until the **Red Arrow** lines up with the other **White Mark**.  
 C. Place the test device horizontally on a clean and level surface with the result window facing up.

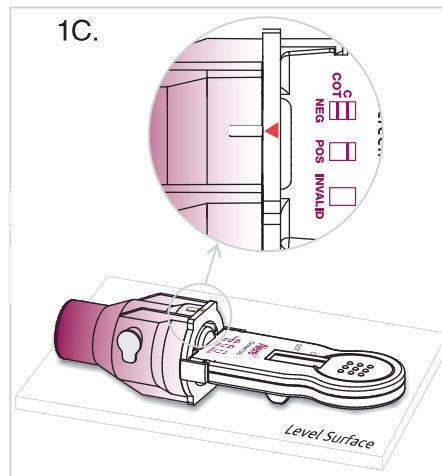
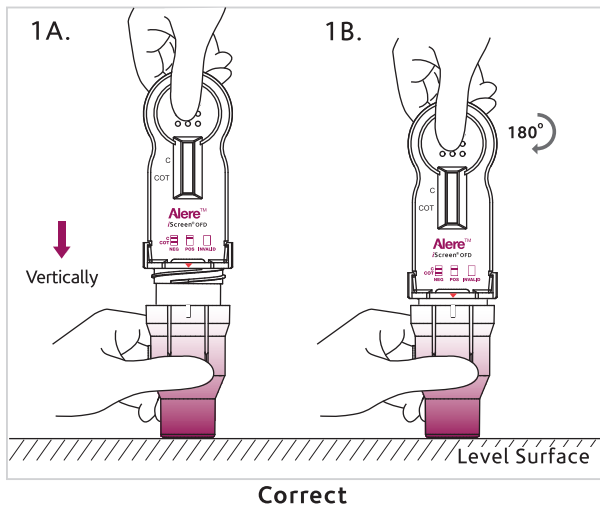
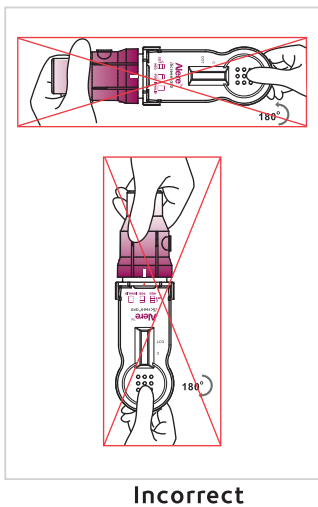

- 2** • Read results at 10 minutes.

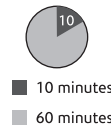

Read the drug strip results at 10 minutes. Test results stable up to 60 minutes.

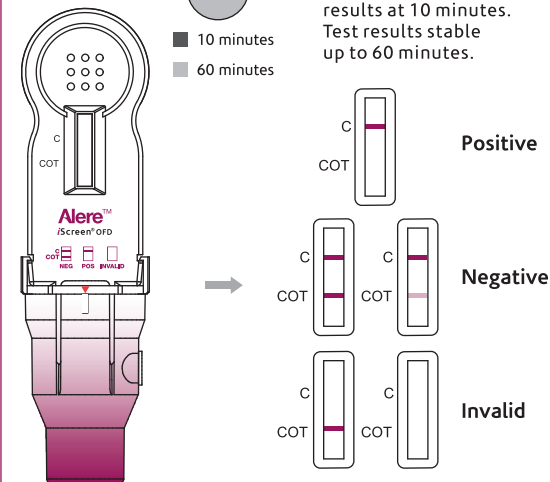

- All positive results are presumptive and should be confirmed by an alternate method. The preferred confirmatory method is GC/MS or GC/MS/MS.

- 3** • If results are positive, secure Cap with Security Seal and send to laboratory for confirmation.

